

R. 27W.

R. 26W.

R. 25W.

T. 62N.

1:500 N. 27W.
1:500 R. 27W.

T. 61N.

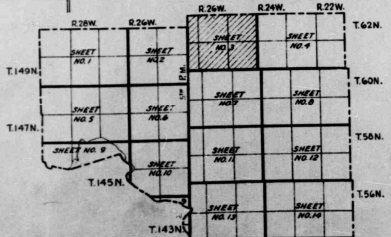
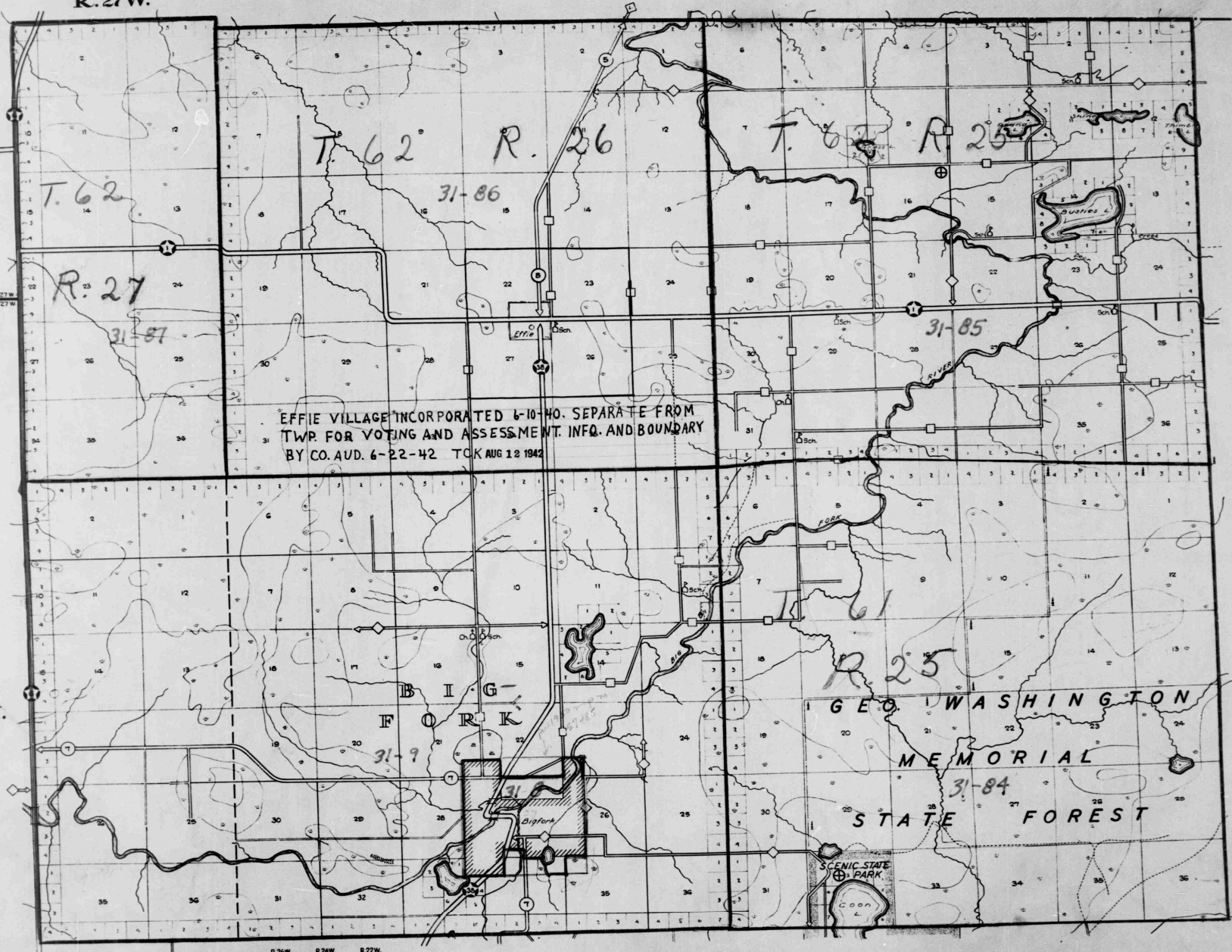

STATE of MINNESOTA
Department of Highways

ITASCA COUNTY
Map Legend

COPYRIGHT - 1936
R. F. 28550

PAVED	TRUNK HIGHWAYS	STATE AID ROADS	COUNTY AID ROADS	COUNTY ROADS	TOWNSHIP ROADS
BIT. TREATED	STATE AID	STATE AID	CO. AID	CO. ROAD	
GRAVELLED					
MAIN. BARTH					
ROAD DIS.					
ROUTES	U. S. 147	STATE 327	STATE AID 328	CO. AID 329	CO. ROAD
RAILROADS					
ELEC. LINES					
OPEN DITCH					

BOUNDARY LINES: STATE, COUNTY, TOWNSHIP, INCORPORATED, TYPE USED

AIRPORT: STATE, COUNTY, TOWNSHIP, INCORPORATED, TYPE USED

COMMERCIAL: STATE, COUNTY, TOWNSHIP, INCORPORATED, TYPE USED

SCHOOL: STATE, COUNTY, TOWNSHIP, INCORPORATED, TYPE USED

DISPENSARY: STATE, COUNTY, TOWNSHIP, INCORPORATED, TYPE USED

RESTAURANT: STATE, COUNTY, TOWNSHIP, INCORPORATED, TYPE USED

TOURIST CAMP: STATE, COUNTY, TOWNSHIP, INCORPORATED, TYPE USED

STORE & FILLING STA.: STATE, COUNTY, TOWNSHIP, INCORPORATED, TYPE USED

PORTS-IMMIGRATION: STATE, COUNTY, TOWNSHIP, INCORPORATED, TYPE USED

CUSTOMS: STATE, COUNTY, TOWNSHIP, INCORPORATED, TYPE USED

COMMISSION: STATE, COUNTY, TOWNSHIP, INCORPORATED, TYPE USED

PARK: STATE, COUNTY, TOWNSHIP, INCORPORATED, TYPE USED

LOGGERS: STATE, COUNTY, TOWNSHIP, INCORPORATED, TYPE USED

MINES & QUARRIES: STATE, COUNTY, TOWNSHIP, INCORPORATED, TYPE USED

IN-PLAN REL.: STATE, COUNTY, TOWNSHIP, INCORPORATED, TYPE USED

INSTITUTIONS-STATE: STATE, COUNTY, TOWNSHIP, INCORPORATED, TYPE USED

COUNTY C: STATE, COUNTY, TOWNSHIP, INCORPORATED, TYPE USED

LIGHTHOUSE: STATE, COUNTY, TOWNSHIP, INCORPORATED, TYPE USED

FOREST-STATE OR NATIONAL: STATE, COUNTY, TOWNSHIP, INCORPORATED, TYPE USED

DEPT. OF HIGHWAYS DIST. NO. 3: STATE, COUNTY, TOWNSHIP, INCORPORATED, TYPE USED

GRAVEL PITS-PRIVATE: STATE, COUNTY, TOWNSHIP, INCORPORATED, TYPE USED

DESIGNATION OF TOWNS

INCORPORATED: STATE, COUNTY, TOWNSHIP, INCORPORATED, TYPE USED

TYPE USED: STATE, COUNTY, TOWNSHIP, INCORPORATED, TYPE USED

POPULATION: STATE, COUNTY, TOWNSHIP, INCORPORATED, TYPE USED

FIRST CLASS CITIES: STATE, COUNTY, TOWNSHIP, INCORPORATED, TYPE USED

SECOND CLASS CITIES: STATE, COUNTY, TOWNSHIP, INCORPORATED, TYPE USED

THIRD CLASS CITIES: STATE, COUNTY, TOWNSHIP, INCORPORATED, TYPE USED

FOURTH CLASS CITIES: STATE, COUNTY, TOWNSHIP, INCORPORATED, TYPE USED

NOT INCORPORATED: STATE, COUNTY, TOWNSHIP, INCORPORATED, TYPE USED

INDEX OF PLACES ON THIS SHEET

PLACE: 1936 POP. LATION: 295

BIGFORK: 295

EFFIE: 40

1940